

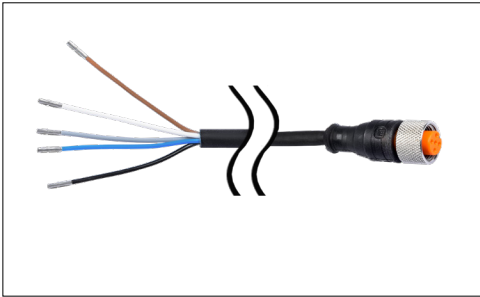

Accessories VA 500 / VA 520 / VA 525

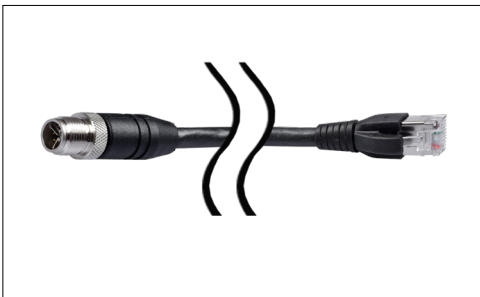

| DESCRIPTION | ORDER NO. |
|--|-----------|
| Connection cable for VA/FA series, 16 ft | 0553 0104 |
| Connection cable for VA/FA sensors, 32 ft | 0553 0105 |
| Connection cable for VA/FA series, 65 ft | 0553 0120 |
| Cable for alarm/pulse output, with M12 plug, 16 ft | 0553 0106 |
| Cable for alarm/pulse output, with M12 plug, 32 ft | 0553 0107 |
| Connection cable for VA/FA series, 16 ft shielded | 0553 0129 |
| Connection cable for VA/FA series, 32 ft shielded | 0553 0130 |



| DESCRIPTION | ORDER NO. |
|---|-----------|
| Ethernet connection cable, length 16 ft, M12 plug x-coded (8 pin) to RJ 45 plug | 0553 2503 |
| Ethernet connection cable, length 32 ft, M12 plug x-coded (8 pin) to RJ 45 plug | 0553 2504 |
| Ethernet connection cable, length 65 ft, M12 plug x-coded (8 pin) to RJ 45 plug | 0553 2505 |



| DESCRIPTION | ORDER NO. |
|---|-------------|
| M12 T-plug for VA 500/520 for connecting multiple sensors to an M-Bus or Modbus network | 0 2000 0823 |



| DESCRIPTION | ORDER NO. |
|-----------------------------|-------------|
| M12 plug for VA 500/520/525 | 0 2000 0082 |
| M12 plug 90° angled | 0219 0060 |

Accessories VA 500 / VA 550



| DESCRIPTION | ORDER NO. |
|---------------------------------------|------------|
| Drilling jig excl. drill (Ø 1/2" BSP) | 0530 1108 |
| Drilling jig excl. drill (Ø 1/2" NPT) | on request |



| DESCRIPTION | ORDER NO. |
|--|-----------|
| Wall thickness measuring device CS 0495 incl. case and calibration block | 0560 0495 |



| DESCRIPTION | ORDER NO. |
|--|-----------|
| Welding nipple, L = 1.3 inch, male thread, R 1/2" stainless steel 1.4301 | 3300 0006 |
| Welding nipple, L = 1.3 inch, male thread, R 1/2" stainless steel 1.4571 | 3300 0007 |



| DESCRIPTION | ORDER NO. |
|---------------------------------------|-----------|
| Ball valve I/I G 1/2" stainless steel | 3300 0002 |



| DESCRIPTION | ORDER NO. |
|--|-----------|
| High-pressure protection recommended for installation from 145 to 725 psi (for VA 400/500) | 0530 2205 |

Order code: **0530 2205 _A1_B1_C1_D1**

| Sensor Type | |
|-------------|-------------------------|
| A1 | VA 500 (up to 725 psi) |
| A2 | VA 550 (up to 1450 psi) |
| A3 | VD 500 (up to 435 psi) |
| A4 | VD 550 (up to 1450 psi) |

| Sensor length | |
|---------------|--------|
| B1 | 160 mm |
| B2 | 220 mm |
| B3 | 300 mm |
| B4 | 400 mm |
| B5 | 500 mm |
| B6 | 600 mm |

| Connection thread | |
|-------------------|----------|
| C1 | G 1/2" |
| C2 | NPT 1/2" |

| Approval | |
|----------|----------------------|
| D1 | without |
| D2 | DVGW (up to 232 psi) |



Accessories VA 500 / VA 550

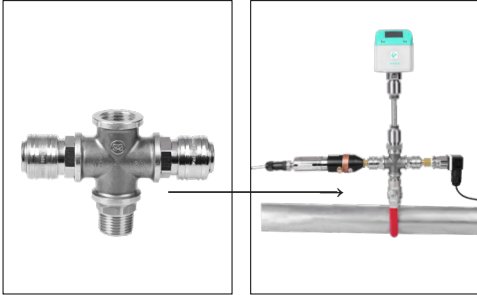

| DESCRIPTION | ORDER NO. |
|---|-----------|
| X-connection for connection of pressure and dew point sensor at the same measuring point (incl. 2x quick-lock coupling) | 0553 0133 |



| DESCRIPTION | ORDER NO. |
|---|-----------|
| Thread adapter G 1/2" female thread to NPT 1/2" male thread | 0553 0134 |

Accessories VA 550 / VA 570

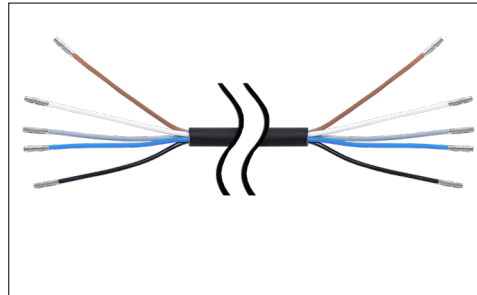

| DESCRIPTION | ORDER NO. |
|---------------------------------------|-----------|
| Connection cable 16 ft with open ends | 0553 0108 |
| Connection cable 32 ft with open ends | 0553 0109 |



| DESCRIPTION | ORDER NO. |
|--|-----------|
| PNG cable gland M20 x 1.5 - for standard | 0553 0552 |
| PNG cable gland M20 x 1.5 - for ATEX | 0553 0551 |

Accessories VA 520 / VA 570



| DESCRIPTION | ORDER NO. |
|--|-----------|
| Closing cap for measuring section VA 520 / VA 570 (material: aluminum) | 0190 0001 |
| Closing cap for measuring section VA 520 / VA 570 (material: stainless steel 1.4404) | 0190 0002 |

Accessories for all VA 5xx



| DESCRIPTION | ORDER NO. |
|---|-----------|
| Mains unit in wall housing for maximum 2 sensors of the series VA/FA 5xx, 100-240 V, 23 VA, 50-60 Hz / 24 VDC, 0.35 A | 0554 0110 |
| Mains unit in wall housing for max. 4 sensors of the series VA/FA 5xx 100-240 V, 23 VA, 50-60 Hz / 24 VDC, 0,35 A | 0554 0111 |



| DESCRIPTION | ORDER NO. |
|--|-----------|
| AC adapter plug 100-240 VAC / 24 VDC for VA/FA 5xx | 0554 0109 |

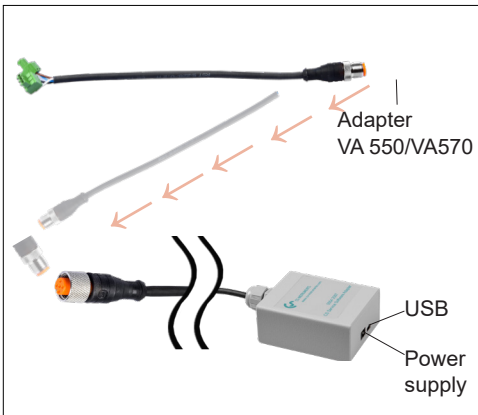

| DESCRIPTION | ORDER NO. |
|---|-----------|
| CS Service Software incl. PC connection set, USB connection and interface adapter to the sensor | 0554 2007 |



| DESCRIPTION | ORDER NO. |
|---|-----------|
| External Gateway PROFIBUS for connection to integrated RS 485 interface | Z500 3008 |
| External Gateway PROFINET for connection to integrated RS 485 interface | Z500 3009 |



| DESCRIPTION | ORDER NO. |
|---|-----------|
| Case for all sensors (dimensions: 19.6 x 14.1 x 4.7 Inches) | 0554 6006 |

Practical measuring section accessories

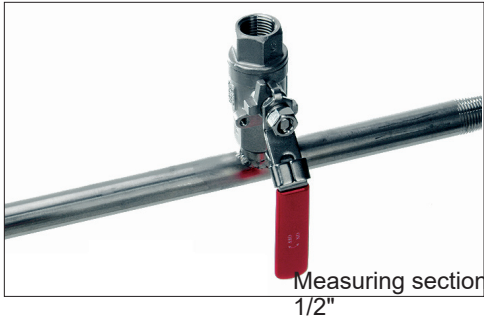

| MALE THREAD | PIPE (OUTER Ø X WALL THICKNESS) | TOTAL LENGTH | ORDER NO. |
|--|---------------------------------|---------------|-----------|
| R 1/2" | 21.3 x 2.6 mm | 19.69 Inches | 4000 0015 |
| R 3/4" | 26.9 x 2.6 mm | 23.62 Inches | 4000 0020 |
| R 1" | 33.7 x 3.2 mm | 29.53 Inches | 4000 0025 |
| R 1 1/4" | 42.4 x 3.2 mm | 35.43 Inches | 4000 0032 |
| R 1 1/2" | 48.3 x 3.2 mm | 39.37 Inches | 4000 0040 |
| R 2" | 60.3 x 3.6 mm | 49.00 Inches | 4000 0050 |
| R 2 1/2" | 76.1 x 3.6 mm | 59.00 Inches | 4000 0065 |
| From DN 80 with flange DIN 2633 | | | |
| DN 80/88.9 | 88.9 x 2.0 mm | 72.38 Inches | 4000 0080 |
| DN 100/114.3 | 114.3 x 2.0 mm | 82.83 Inches | 4000 0100 |
| DN 125/139.7 | 139.7 x 3.0 mm | 112.60 Inches | 4000 0125 |
| DN 150/168.3 | 168.3 x 3.0 mm | 122.44 Inches | 4000 0150 |

Measuring sections for precise measurements:

Measuring section in stainless steel 1.4301 incl. ball valve, up to 2 1/2" with R-male thread, from 3" with weld neck flange in acc. with DIN 2633.

Practical hot tapping saddle accessories for compressed air lines



| DESCRIPTION | Ø | ORDER NO. |
|---|--------|-----------|
| Spot drilling collar for pipe Ø 032 - 036 mm, length: 3.9 Inches* | | 0500 0446 |
| Spot drilling collar for pipe Ø 036 - 040 mm, length: 3.9 Inches* | | 0500 0448 |
| Spot drilling collar for pipe Ø 040 - 044 mm, length: 6.1 Inches* | | 0500 0449 |
| Spot drilling collar for pipe Ø 044 - 051 mm, length: 7.8 Inches* | | 0500 0610 |
| Spot drilling collar for pipe Ø 048 - 055 mm, length: 7.8 Inches* | 1 1/2" | 0500 0611 |
| Spot drilling collar for pipe Ø 052 - 059 mm, length: 7.8 Inches* | | 0500 0612 |
| Spot drilling collar for pipe Ø 057 - 064 mm, length: 7.8 Inches* | 2" | 0500 0613 |
| Spot drilling collar for pipe Ø 063 - 070 mm, length: 7.8 Inches* | | 0500 0614 |
| Spot drilling collar for pipe Ø 070 - 077 mm, length: 7.8 Inches* | 2 1/2" | 0500 0615 |

- * incl. 1/2" ball valve
- * not suitable for copper and plastic pipes
- * not suitable for aluminum

If there is no measuring site with 1/2" ball valve present on existing pipes, it can be set up quickly and cost-effectively by means of hot tapping saddle. The hot tapping saddle is imposed onto the pipe and tightened via thread rods. The enveloping rubber gasket is pressure-tight up to 11 bar (159 psi). By means of the drilling jig, it is possible to drill the hot tapping saddle through the 1/2" ball valve into the existing pipe.

Important: Please indicate the exact outer diameter of the existing pipe when placing the order resp. please select the suitable hot tapping saddle from the adjoining list.

Practical accessories: Hot tapping saddle for installing insertion sensors during operation

Sample order code:
0500 0800_A1_B1_C1

| Outer pipe diameter | |
|----------------------------------|----------------|
| A20 | Ø 075 - 105 mm |
| A21 | Ø 090 - 120 mm |
| A22 | Ø 110 - 140 mm |
| A23 | Ø 135 - 165 mm |
| A24 | Ø 165 - 195 mm |
| A25 | Ø 195 - 225 mm |
| A26 | Ø 220 - 250 mm |
| A27 | Ø 250 - 280 mm |
| A28 | Ø 275 - 305 mm |
| A29 | Ø 305 - 335 mm |
| Other sizes available on request | |

| Ball valve | |
|------------|---------------------------------------|
| B1 | For sensors with 1/2" screw-in thread |
| B2 | For sensors with 3/4" screw-in thread |

| Screw-in thread | |
|-----------------|------------|
| C1 | G thread |
| C2 | NPT thread |

TECHNICAL DATA HOT TAPPING SADDLE

| | |
|--------------------------------------|---------------------------------|
| Material of clamp upper part: | Cast iron GJS-400, epoxy-coated |
| Strip material: | Stainless steel, AISI 316 |
| Belt width: | 65 mm, EPDM tape |
| Standard rubber seal: | NBR |
| System pressure: | maximum 159.5 psi |
| Operating temperature: | 14°F...122 °F |

When using a hot tapping saddle, please allow for a 100 mm longer sensor shaft.
The hot tapping saddle are not suitable for copper, aluminum, and plastic pipes.
*Only available for 1/2" insertion sensors.

